



Quality of life since 1825

# Wall hung toilet 5G84 – Hygienic Flush

With Soft Close/Quick Release seat.

## Product features



- Easy-to-clean and minimalist design
- Open flush edge for simplified cleaning
- Flushes all the way up to the rim

## Article numbers

Art-no.  
5G84HR01

EAN  
4051202288662

## Packaging information

Length: 410 mm | Width: 415 mm | Height: 570 mm

Weight: 25.75 kg

Weight: 1 pc

## Assembling & Care

Intended for installation with our Triomont fixtures. Mounted with bolts directly on the wall. Washers, bushings and nuts (M12) included, but not bolts (included with Triomont fixture). Bolt projection from finished wall must be  $70 \pm 2$  mm. See included installation instructions.

## Energy labeling and certifications

- Complies with Safe Water installation requirements CE approved

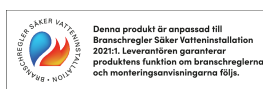

## Technical information

- CO2 Footprint: 55.7 kg
- Flushing - water quantity: 4,5/3 Dual flush 4,5/3 (L)
- Standard connection dimension: c/c 155mm sitsfäste

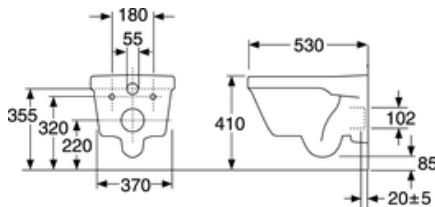

## Spare parts

---

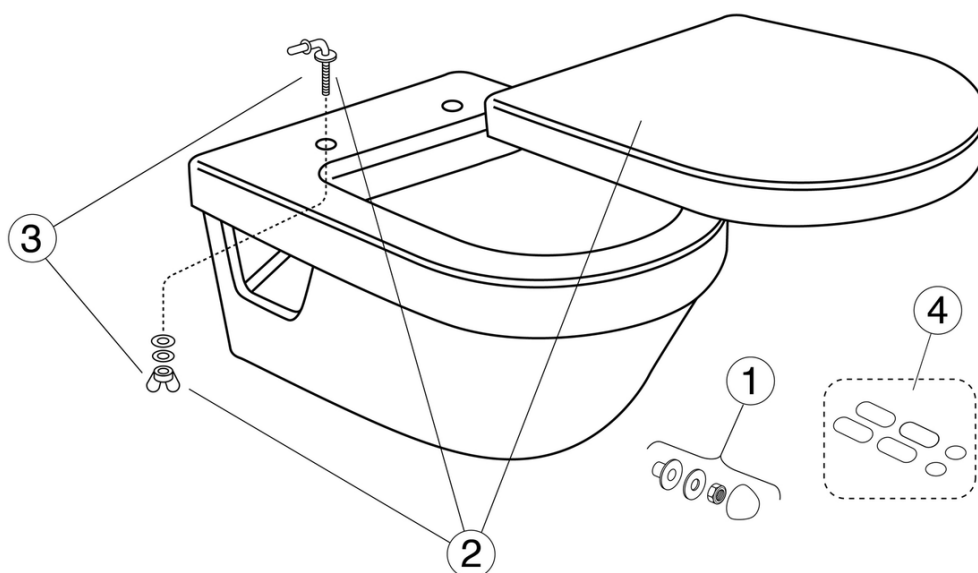

No.	Product	Art-no.
1	Wall-mounting kit	92185901
2b	Toilet seat - SC/QR	9M16S136
2c	Hard seat	98895136
2d	Toilet seat - SC/QR	9M16S101
2e		92242400
3a	Hinges	92241761
3b	Hinges	92237061
4a	Buffer set	92236800
4b		92242201